

OADBY SUITE FLOOR PLAN

(W – Window; FD – Fire Door; LCD – TV; P – Pillar)

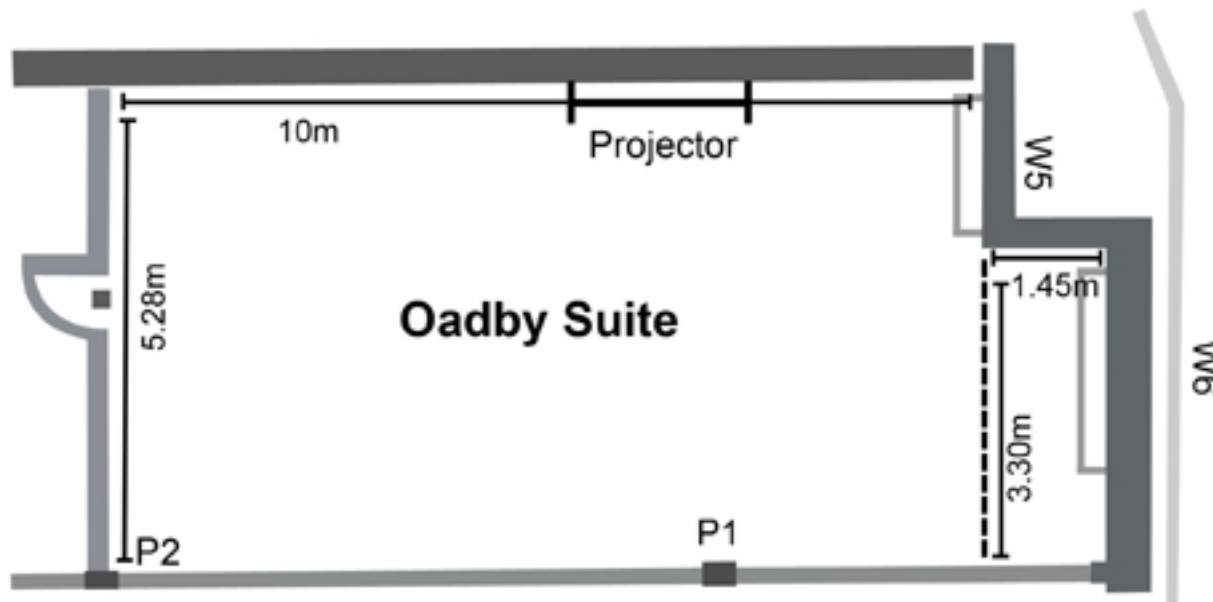

Oadby Suite: 10m x 5.28m
and 3.30m x 1.45m

Ceiling Height: 2.42m

Window 5: 1.59m x 79cm

Window 6: 2.45m x 81cm

Sockets: 6 Double (12 Total)